



East Suffolk  
Community  
Partnerships  
*Bringing ideas to life*

## East Suffolk Community Partnership Annual Forum

Friday 3 March 2023

Trinity Park Conference Centre

# Venue Plan

### Outside Area

Rural Coffee Caravan

Level 2 Youth Project Bus

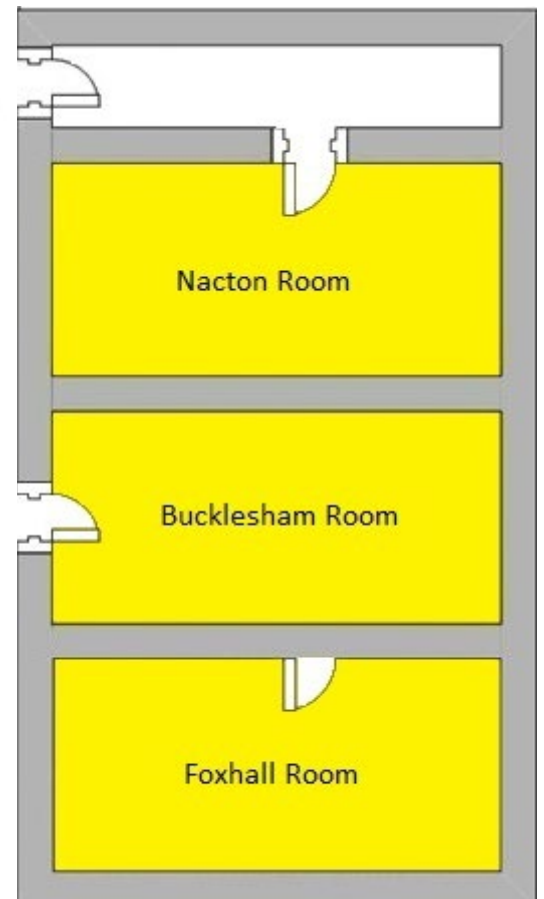
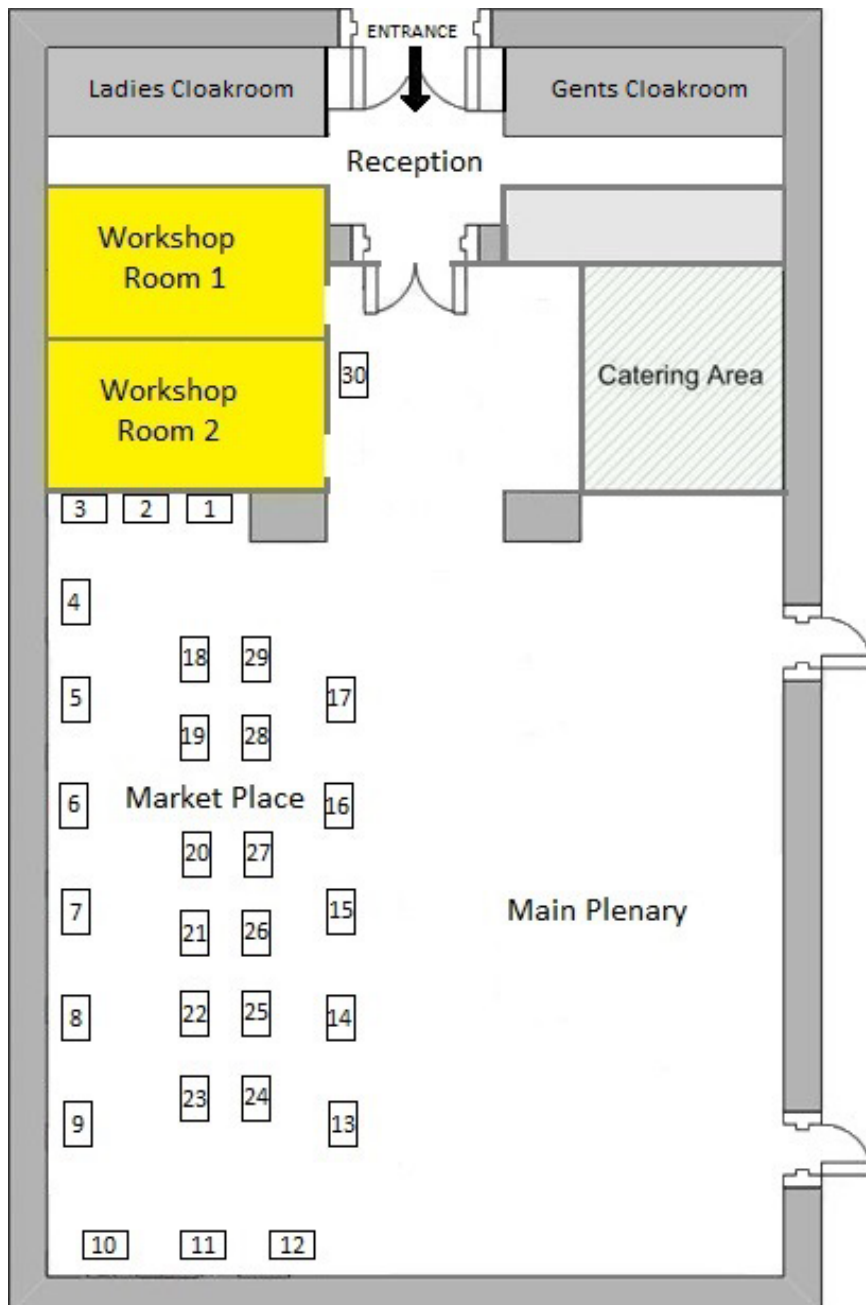

Stall Number	Organisation	Description of Organisation/Project
1	Economic Development & Regeneration East Suffolk Council	<p>East Suffolk Council's Economic Development and Regeneration team reinvigorate the local economy through physical regeneration whilst enhancing the local environment and our towns to support economic growth and prosperity.</p> <p>We encourage new and existing businesses to survive, revive and thrive, making our district more attractive to residents, visitors and investor alike.</p> <p>Our team also provide ongoing support to the development of a stringer skill base to future-proof tomorrow's generation, today.</p>
2	Menta <a href="http://www.menta.org.uk">www.menta.org.uk</a>	<p>MENTA are the one stop destination for new business advice, training and ongoing support.</p> <p>With business hubs in Haverhill, Felixstowe, Bury St Edmunds, Brandon, and Southwold*</p> <p>Our team of industry experts and coaches can help build business plans, shape marketing, and enrich digital skills.</p> <p>We have funded programmes that cover new business start-ups and self-employment - these are blended learning with online sessions as well as face to face training.</p> <p>Established businesses can benefit from a series of digital skills support and training that has been designed to raise awareness and sales online.</p> <p>MENTA delivers networking events across Suffolk, offers freelancers and the self-employed co-working space and for established businesses, MENTA has serviced business units which offer an opportunity to grow business with ongoing business support.</p> <p>MENTA is a non-membership and non-for-profit organisation that has served the business community of Suffolk for nearly 40 years.</p>
3	Funding Team East Suffolk Council <a href="#">Cost of Living Community Grant Fund</a>	<p>The Funding Team supports organisations and groups to access grant funding. The work involves general funding support including signposting and advice to VCSEs. The team also administers internal grant funding programmes within the Council such as the Cost of Living Community Grant Fund, Community Partnership budgets and Enabling Communities Budgets.</p>
4	Bungay Town Council <a href="http://www.bungaytowncouncil.gov.uk">www.bungaytowncouncil.gov.uk</a>	<p>Bungay is snuggled in between the sea and the countryside providing a wealth of things to do in the Town &amp; beyond. Today, visitors can enjoy the theatre, exploring the history of the Town, it's shops, restaurants &amp; cafes.</p>

		<p>The natural beauty of the surrounding area with far ranging views over verdant water meadows, which flood most winters, but fringed with silver green willows and grazed by cattle in the summer months, creating a tranquil, beautiful landscape.</p> <p>Come and talk to our town team and start planning your visit today!</p>
5	<p>ActivLives <a href="http://www.activlives">www.activlives</a></p>	<p>ActivLives is a local charity, which has been working in Ipswich and across East Suffolk for 17 years.</p> <p>We work with all age groups, but mainly people 55 years and over. We support and motivate people to improve their own health and well-being; keep people connected with their communities to reduce social isolation and loneliness and provide access to learning, training and volunteering opportunities to enable people to gain skills and employment.</p> <p>We provide a wide range of opportunities such as Community singing, physical/sport activities, seated and OTAGO falls prevention exercise and social activity.</p>
6	<p>Active Suffolk <a href="http://www.activesuffolk.org">www.activesuffolk.org</a></p>	<p>Active Suffolk is the Active Partnership for Suffolk, one of 43 Active Partnerships across England dedicated to increasing the number of people taking part in sport and physical activity.</p> <p>We work with a wide range of partners including local authorities, national governing bodies (NGB's), the education sector, the health sector, charitable/voluntary organisations to support people in Suffolk to lead healthy, active lives.</p>
7	<p>Communities Together EA <a href="http://www.communitiestogetherastanglia.org">www.communitiestogetherastanglia.org</a></p>	<p>Supporting Suffolk people &amp; communities with vital services to help stay connected.</p> <p>Our core services are Community Transport, Suffolk Carers Matter &amp; Later Life Community.</p>
8	<p>Level Two Youth Project <a href="http://www.leveltwo.org">www.leveltwo.org</a></p>	<p>We provide services for young people aged 7-25 living in Felixstowe &amp; surrounding area.</p> <p>Our Youth Hub offer a safe space for weekly drop-in, open access sessions. Our 1-1 mentoring provision supports young people with mental health challenges.</p> <p>Our qualified &amp; registered staff provide counselling. During school holidays these sessions continue along with trips &amp; visits.</p> <p>Our Detached teamwork with young people less likely to access Centre Based provision. We also have a new Mobile provision</p>

		taking resources and opportunity beyond Felixstowe. We also work in all 8 schools in Felixstowe & 4 neighbouring villages.
<b>9</b>	Net Zero Leiston <a href="http://www.netzeroleiston.info">www.netzeroleiston.info</a>	An ambitious and exciting project aimed at delivering a greener, more prosperous future for Leiston. Aimed at engaging our community in fighting climate change and helping other communities to do the same.
<b>10</b>	Felixstowe Chamber of Commerce	<p>An association of local businesses that have a common aim of supporting one another and representing our combined interest in the community.</p> <p>Non-political, so can support or oppose any proposals that affect the business community. Linked to Suffolk Chamber of Commerce (and through that the British Chamber of Commerce) offering our members their benefits and discounts.</p> <p>We have an Executive Committee of members who meet monthly to discuss business development and promotional opportunities in Felixstowe and the surrounding villages, to lobby on behalf of businesses, and to discuss relevant issues including town centre, visitor economy and important review planning applications. We organise regular networking events, social functions, Business related seminars and workshops, Support for local charities, advertising &amp; promotion within local &amp; national media, a website with a directory of members and newsletters to keep members in touch with progress.</p> <p>Get involved in the business life of the town and join our not-for-profit organisation. Run by members for our members, all the money that we make through our networking events and initiatives is invested into the Chamber, helping to pay for the services you receive.</p>
<b>11</b>	Lighthouse Training & Development Ltd <a href="http://www.lighthouse-group.co.uk">www.lighthouse-group.co.uk</a>	Specialist Leadership & Management Training Provider.
<b>12</b>	Coastal Partnership East <a href="http://www.coasteast.org.uk">www.coasteast.org.uk</a>	<p>Coastal Partnership East brings together the coastal management resources and expertise from Great Yarmouth Borough Council, North Norfolk District Council and East Suffolk Council.</p> <p>Our Resilient Coasts programme sees us delivering real adaption and resilience options for our communities.</p> <p>To do this, we are proactively working together with coastal communities in carefully selected pilot locations to develop a practical toolkit of options enabling them to be actively engaged in shaping the future of their place on the coast.</p>

		Using this approach, our coastal communities become the architects of change and not its victims.
<b>13</b>	Suffolk County Council Community Information Team	<p>Suffolk County Council Community Information Team manages information on service provision and development via key projects, including Suffolk Info Link, the Suffolk Information Partnership and Warm Handover Scheme and the Suffolk-wide Digital Inclusion Network and Digital Champions Programme.</p> <p>We aim to improve outcomes for our residents by providing clear, accessible, secure and sustainable sources of information and effective pathways into services.</p> <p>We also aim to work in partnership to improve access to services by identifying key areas of need and providing solutions to reduce digital poverty.</p>
<b>14</b>	Communities Catalysts <a href="http://www.communitycatalysts.co.uk">www.communitycatalysts.co.uk</a>	Community Catalysts is a social enterprise working across the UK to try to make sure that people who need care and support to live their lives can get that help in ways, times and places that suit them, with real choice of attractive local options. Community Catalysts in Suffolk run a development programme to help local people to set up small enterprises, and ventures that offer care and support at home for older people. We also help enterprise leaders to work together in peer networks, supporting and learning from each other.
<b>15</b>	Waveney Health & Wellbeing	Access Community Trust, Citizen Advice East Suffolk, Physical Health & Wellbeing Network and the VASP Mental Health Network are showcasing what help and support is available across Waveney in the area of Health and Well-Being, including Mental Health, and the 2 networks that help support those VCSE organisations
<b>16</b>	Integrated Neighbourhood Teams and Connect Spaces representing – Saxmundham and North East Woodbridge Felixstowe	An opportunity to hear how Health Professionals and a range of Statutory and VCSE sector groups and organisations are working collaboratively to identify localised priorities and deliver solutions to address health inequalities, reduce demand on front line services, and improve the overall health and wellbeing of our communities.
<b>17</b>	Community Action Suffolk (CAS) <a href="http://www.communityactionsuffolk.org.uk">www.communityactionsuffolk.org.uk</a>	<p>Community Action Suffolk (CAS) is the 'to go to' organisation for Voluntary, Community &amp; Social Enterprise (VCSE) organisations in Suffolk.</p> <p>We exist to ensure the sector is supported, safe and sustainable. We provide (or signpost) whatever is needed behind the scenes to enable this, so the sector can concentrate on doing what it does best – making Suffolk an incredible place in which to live and work.</p> <p>CAS supports organisations in the sector to enable them to operate more effectively.</p>

		<p>We provide voice for organisations and groups who may not otherwise be heard and represent their interests to the private and public sectors.</p> <p>We do this through conferences, workshops, events, specialist networks, and by consultation with the sector.</p> <p>We work closely with a wide variety of partners from other sectors including Suffolk County Council, Borough and District Councils, Town and Parish Councils, Health and Police, along with partners from the private sector such as New Anglia Local Economic Partnership and local businesses. All these parties have a vital role in improving the lives of people in Suffolk and by working together we ensure Suffolk is the best place it can be for all those living and working here.</p> <p>The Good Neighbour Scheme is a voluntary initiative run by a group of local residents who want to help their people in their locality to enjoy a better quality of life by offering them support with everyday tasks. This helps to build a stronger and more resilient community where people know each other and help out where needed.</p> <p>CAS also manage the Volunteer Suffolk website. VCSE organisations can advertise volunteer roles for free.</p>
18	<p>East Suffolk Greenprint Forum  <a href="http://www.eastsuffolk.gov.uk/environment/east-suffolk-greenprint-forum/">www.eastsuffolk.gov.uk/environment/east-suffolk-greenprint-forum/</a></p>	<p>The Greenprint Forum is a voluntary network of people and organisations who aspire to enabling community environmental action in east Suffolk.</p> <p>Our purpose is to connect and support community, organisational and youth champions and elected representatives to enable them to help the people of east Suffolk work together to improve our quality of life and living standards, whilst reducing our environmental impact.</p> <p>We aim to do this by facilitating discussions, providing training, organising events and linking research to need and where need is identified helping to draw in resources to enable action.</p>
19	<p>RABI – The Royal Agricultural Benevolent Institution  <a href="http://www.rabi.org.uk">www.rabi.org.uk</a></p>	<p>The Royal Agricultural Benevolent Institution – RABI – is an award-winning national charity providing local support to the farming community across England and Wales. Established in 1860, we have been offering guidance, financial support and practical care to farming people of all ages for generations.</p> <p>The charity also provides help with mental well-being, from 1:1 counselling and online platforms accessed 24/7. A range of grant support programmes are available to individuals, including enduring and single grant awards.</p>

		We also award funding to other not-for-profit organisations to support activities that fulfil our charitable objectives.
20	Combat2coffee <a href="http://www.combat2coffee.co.uk">www.combat2coffee.co.uk</a>	Veterans outreach project working with veterans in the community and prison to train them in barista skills and roasting of coffee.  Have outreach vehicles to serve hot drinks and have conversations with people providing help and support to other agencies where required.
21	Felixstowe Old Peoples Welfare Association <a href="http://www.fopwa.onesuffolk.net">www.fopwa.onesuffolk.net</a>	1 Broadway House, Orwell Road, Felixstowe 55+age Centre Mon – Fri morning and afternoon and Saturday morning only.
22	Rural Coffee Caravan <a href="http://www.ruralcoffeecaravan.org.uk">www.ruralcoffeecaravan.org.uk</a>	The Rural Coffee Caravan uses free, mobile, pop up information cafes to connect residents in rural locations to each other, to their immediate and wider communities and to sign post to services that aid a happy healthy independent life.
23	Involve Active Ltd <a href="http://www.involve-active.co.uk">www.involve-active.co.uk</a>	Involve Active Ltd is a not-for-profit organisation that is committed to listening to and building on the needs and aspirations of children, young people and adults with additional needs and SEND's. We offer daily programmes and activities in a  safe friendly environment, where service users can explore different interests, gain new skills and become more confident to be independent and engaged in the community and world of work.  Our services offer a choice of different activities either based at the Involve Centre Lowestoft or at our outdoor education centre Goldcrest at Mutford. Our service offer supports service users to feel more independent, valued, enabling them to have a voice, be part of a community, less isolated, healthier, increase social engagement, engaged in learning new skills and work experience, becoming better equipped to face the wider world.  We feel passionate about breaking down barriers to participation and enabling everyone the opportunity to be the best they can be.
24	Suffolk Office of Data & Analytics (SODA) <a href="http://www.suffolkobservatory.info/soda/">www.suffolkobservatory.info/soda/</a>	Suffolk Office of Data & Analytics (SODA) & the Suffolk Observatory – Suffolk's public service organisations believe that a shared and high-quality evidence base enables better decision making to improve the lives of Suffolk residents.  SODA has been set up to make better use of data to generate new insights into public services and the needs they serve – applying these insights to improve policy/service design/delivery.  The Suffolk Observatory provides a comprehensive picture of the County and is a great source for useful facts and figures that will help you write reports and presentations, inform strategic



		and business planning, prepare funding, applications, or support academic research.
25	Terrence Higgins Trust <a href="http://www.tht.org.uk">www.tht.org.uk</a>	We provide HIV and Sexual Health interventions throughout Suffolk, offering Adult Services and Young Peoples services, this could be in ways such as testing opportunities, free condoms, C-Card Scheme, numerous Training and outreach in the community.
26	Get Suffolk Reading <a href="http://www.getsuffolkreading.org.uk">www.getsuffolkreading.org.uk</a>	<p>Get Suffolk Reading inspires families across the county to read together and helps parents to support their children's literacy skills. We also work with schools to aid to aid the teaching of literacy and partner with local organisations who support our mission to raise literacy levels across the county.</p> <p>If you would like to get involved, please <a href="mailto:getsuffolkreading@literacytrust.org.uk">getsuffolkreading@literacytrust.org.uk</a> and sign up to our newsletter for regular updates. Get Suffolk Reading is funded by Suffolk County Council and was established with the support of Suffolk Public Sector Leaders.</p>
27	Healthwatch Suffolk <a href="http://www.healthwatchsuffolk.co.uk">www.healthwatchsuffolk.co.uk</a>	<p>We're here to find out what you think about NHS and social care in Suffolk.</p> <p>We use the things you tell us to shape, influence and improve care across the county.</p>
28	Judicial Office – <a href="http://Suffolk Magistrates">Suffolk Magistrates</a> <a href="https://magistrates.judiciary.uk/">https://magistrates.judiciary.uk/</a>	<p>Magistrates are volunteers with no previous legal experience, who come from all walks of life.</p> <p>They make vital decisions on a variety of cases in the criminal court and family court – helping to protect, enhance and transform people’s lives.</p>
29	Anglia Care Trust <a href="http://www.angliacaretrust.org.uk">www.angliacaretrust.org.uk</a>	<p>Anglia Care Trust provides a range of services to vulnerable individuals and families. These include Domestic Abuse Support, Supported Housing, Specialist Money Advice, Mental Health Support and Drug and Alcohol Outreach Services.</p> <p>In addition to 64 paid staff, our organisation encompasses a team of over 200 volunteers supporting our services.</p> <p>We provide a wide range of volunteering opportunities for those wishing to support their local communities.</p> <p>Our services give people the stability, support and challenge they need to enable them to realise their full potential. Essentially, our services fall into three main categories:</p> <ol style="list-style-type: none"> <li>1. Helping people to keep a roof over their heads</li> <li>2. Helping people to stay safe</li> <li>3. Helping people to be heard</li> </ol>



<b>30</b>	Communities Team East Suffolk Council	East Suffolk Council's Communities Team empowers communities to make the area where they live or work into the place, they want it to be. We support each community to identify their ambitions and the assets that they can build upon to achieve them through 8 Community Partnerships that cover East Suffolk. We then help them to reach their goals by providing practical advice and in-depth knowledge, by unlocking creativity, identifying opportunities to work in partnership - and providing enabling funding for community projects.
-----------	--	---